

SZ818

Finish product code
XXXXXXXXXX

Primary packaging

90 tablets

Secondary packaging

90 tablets
1 pillbox

Outer packaging

60 cartons

36 shippers
2160 cartons

TABLET

Oblong 18.9*8.38*7.7 mm (axbxh)

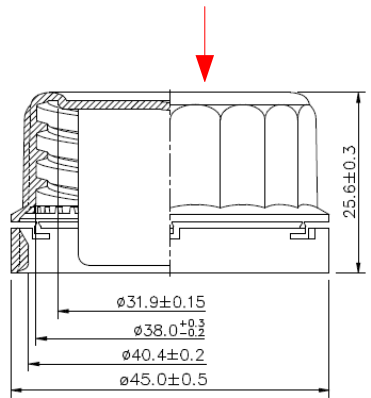
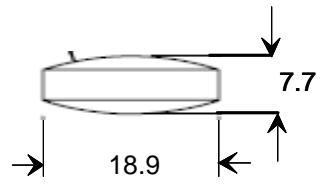

Cap : 03827T-300T
avec dessiccant

SB877

SB915 Pill : 045156 150 ml

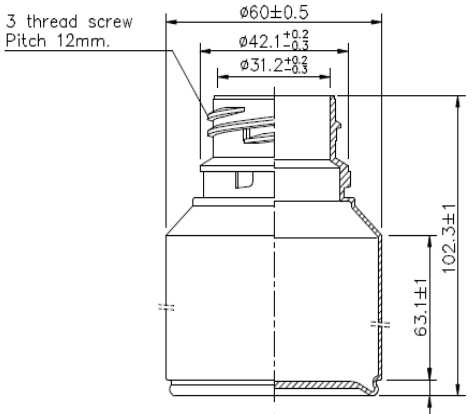

LABEL SB1934/ SB1938

145*50 mm

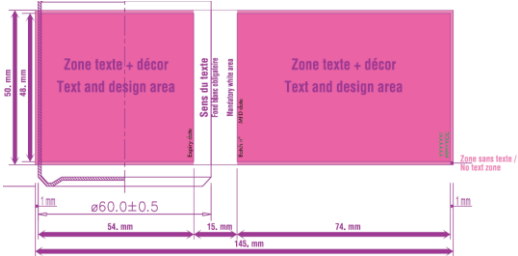

CARTON

PATTES OPPOSEES

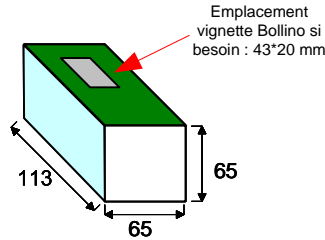

SHIPPER SB431

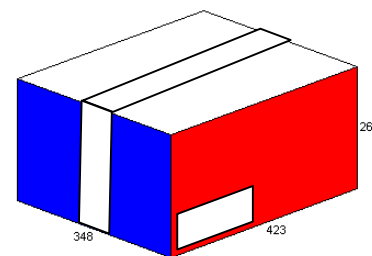
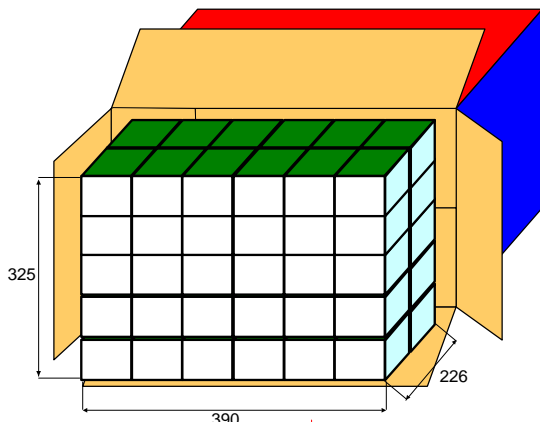

Dim.caisse int.(mm): 415*340*245
Dim. caisse ext.(mm): 423*348*261
shipper label: 200*80 mm

PALLET

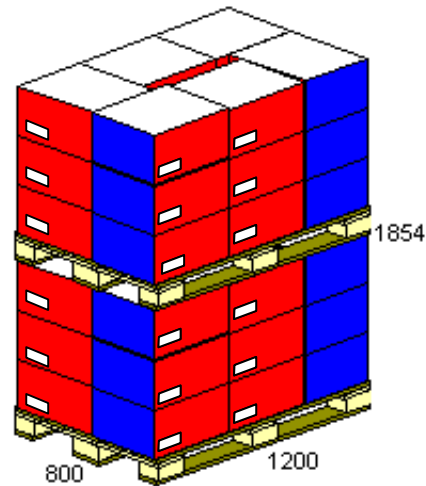

Euro pallet with NIMP15 treatment

Pallet weight :
25 kg

Pilulier 150 ml / 90's				
DATE	29/07/2020	VISA Date	Validation Packaging / Packaging approval	Validation Client / Customer approval
MODIF	New		Vanessa STROPPOLO	